

## 25600-SH Floating Skimmer

3000 gpm / 11.4 m<sup>3</sup>min capacity

# skim-pak®

### Flow - Control and Skimmer Systems



#### System Features:

- Constructed of marine grade aluminum.
- Capable of 3000 gallons per minute.
- Two “flow-controlled” inline weirs, in two separate chambers within the skimmer.
- Two 6” diameter exit ports on the back of the skimmer connect to each of the weir chambers.
- Three floatation chambers on top of the skimmer have fill and drain plugs for ballasting the skimmer in heavy sea states.
- Lifting points on top of the skimmer facilitate attaching cables.

Two low mass flow control weirs efficiently skim the oil from the surface with a minimum of water and control the separation of the oil. The low mass characteristic of the weir allow the controlling float to reposition it immediately in response to waves, and allow this positioning to take place independent of the motion. There are many advantages of this type of straight weir over the common circular weir. The most significant being the ability of the unit to be deployed in an advancing configuration.

The first weir pulls floating oil and water into the skimmer head depositing it in the first chamber. The second weir skims the fluid from the first chamber; collecting mostly oil in the second chamber. The first chamber discharges oil and water through the exit port. The second chamber discharges mostly oil through its exit port.

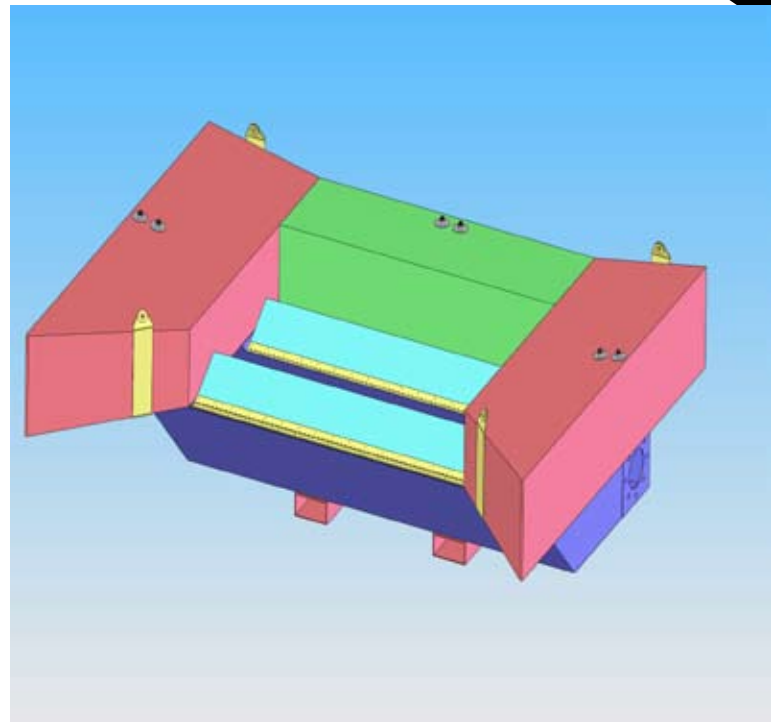

The model 25600-SH is an inline floating weir skimmer for use in large oil spill applications.

#### Model 25600-SH

Dimensions	108 x 82 x 42 in.
Weight	2500 lbs.
Material	Marine grade aluminum
Port Sizes	6 in.

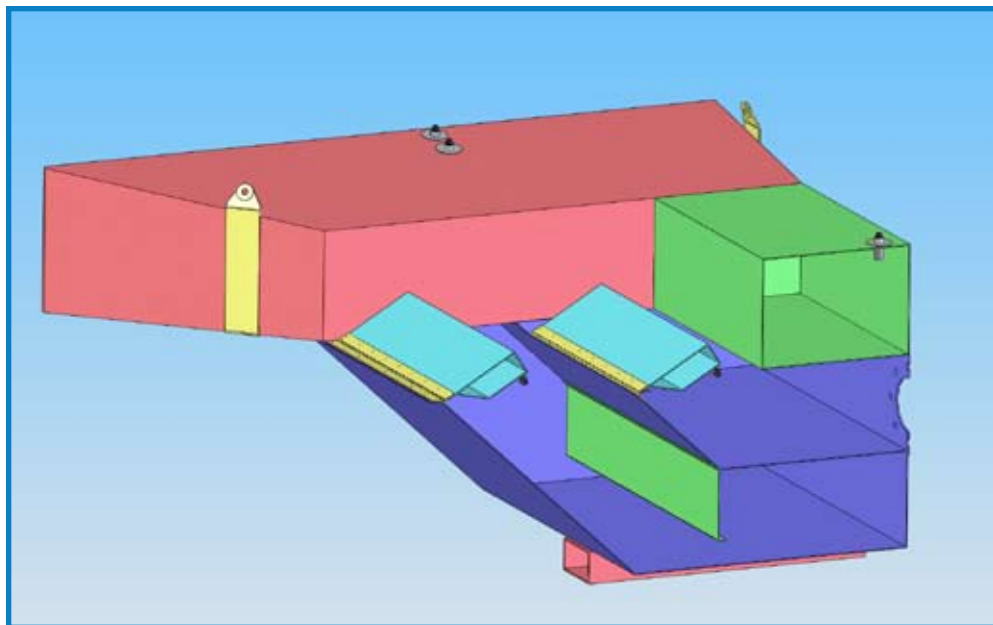

SKIM-PAK 25,000 DOUBLE WEIR SELECTIVE SKIMMER

REV	DATE	DESCRIPTION

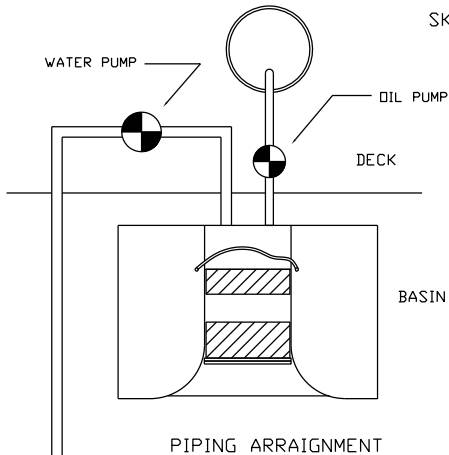
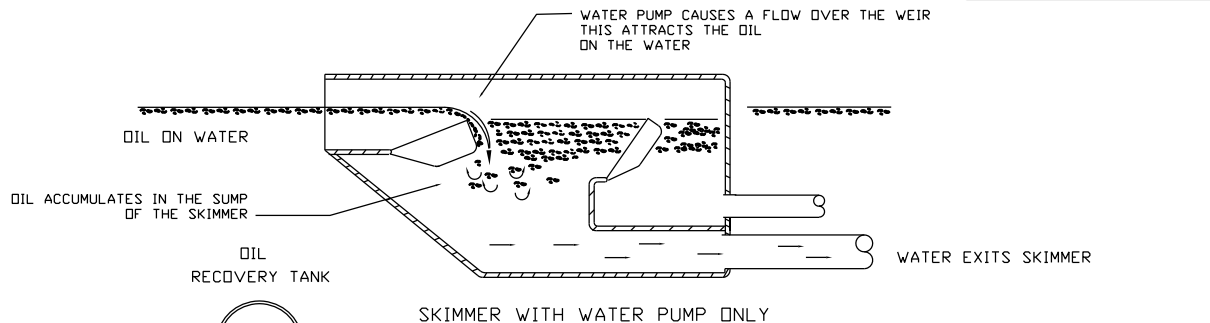

WATER RETURNED TO BASIN

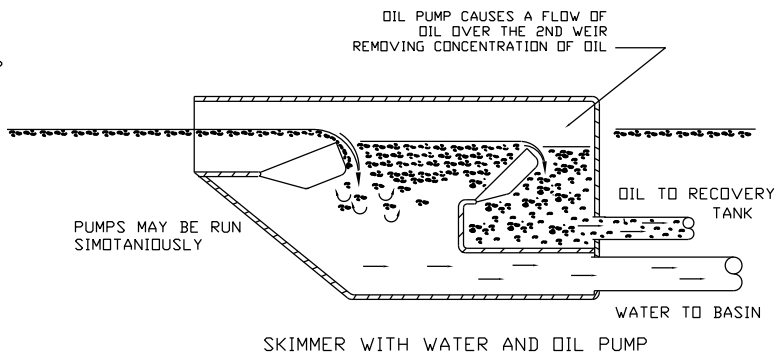

SKIM-PAK 25000	
SEPARATING, DOUBLE WEIR	
DATE 4/05/08	DWG NO